

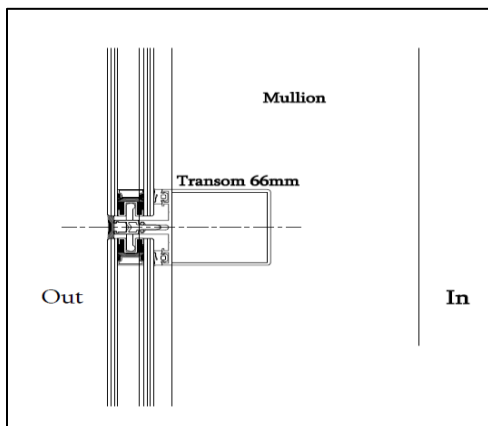

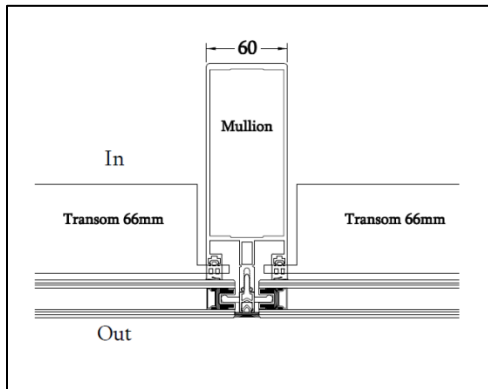

Structural Glazed Curtain Wall Optimus SG 60



Optimus CW60 system is designed for the increasing demand of heavy duty curtain wall and skylights.

The system has a self-bearing structure, comprising 60mm wide aluminum mullions and transoms with different mullions and transoms depth to suit most construction requirements or glass arrangements requirements.

The CW60 is a versatile and comprehensive system, integrating with several types of opening windows and doors, including the entire conventional **Optimus** product range.

SG60 Design Features

- Structural sections have two channels to ventilate the glazing compartment and to drain water infiltration outwards
- Glazing infill range of 6mm to 40mm
- Fully integrated Open Out and Open In window and door options
- 60mm sightline
- Sloped roofs and roof light options also available
- Faceted profiles available for a range of angles including 90 degree corner post
- Can be integrated with:
 - Push out projecting windows with structural glazing
 - Open In and Open Out Door

SG60 Options

Options

- Available in single or dual color option, polyester powder coating and anodized finishes
- Fully integrated with a range of Optimus window and door systems
- Capped and structural glazed (Wet & Dry gasket) solutions are available

Applications

- Vertical façade Curtain wall
- Inclined façade curtain wall
- Skylights and glazed sloped roof.







Cap System Curtain Wall Optimus CW 60

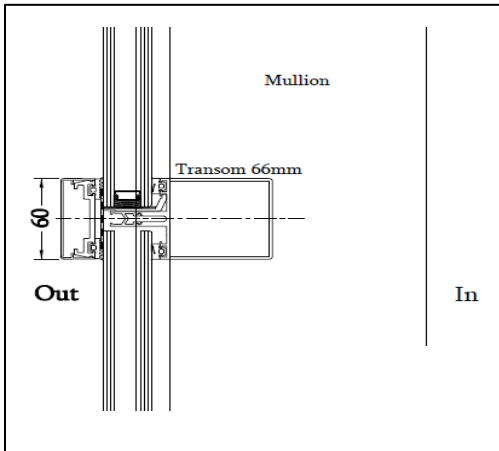
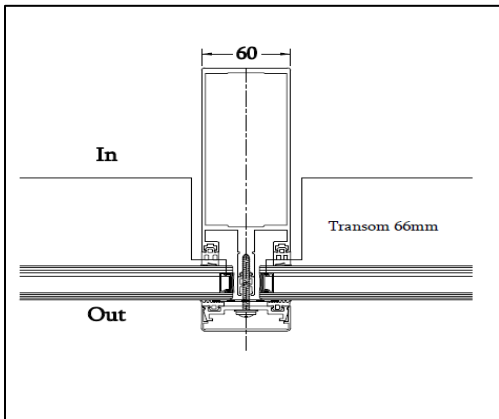

CW60 Design Features

- Horizontal and Vertical Aluminum cap is fixed outside the glass panel.
 - Aluminum finish can be anodized or powder coated as per design requirements.
 - Glazing infill range of 6mm to 40mm
 - Fully integrated with ;-
- Push out window
 - Hinged and Tilt windows
 - Open in or open outdoors.
 - Sunshades and external louvers as per design requirements.

CW60 Options and Configurations

Options

- Available in single or dual color option, polyester powder coating and anodized finishes
- Fully integrated with a range of **Optimus** window and door systems
- Capped and structural glazed (Wet & Dry gasket) solutions available.

Configurations

- Flexible design allows CW60 to be tailored to suit your project needs
- Multiple construction options including traditional shear block, T-connectors, front loaded transoms with sprung T-connectors and special profiles that permit semi-unitized off-site construction
- Concealed mullion drainage options and zonal drainage option
- Varying mullion depths allowing a wide range of achievable values
- Wide range of mullion depths ensures maximum structural optimization





Sliding System Thermal Break Optimus S.T.B. 160.

The S.T.B.160 aluminum sliding door is a multi-configuration in-line sliding system that allows you to specify and design the most suitable solution for your project.

The system is designed to cover the needs of wide sliding windows and doors.

Thermally broken system profiles with integrated fly screen track and sash is designed to cover market needs.

The system is available with fixed and sliding panels, as well as single and double track options. Outstanding thermal performance and the highest quality fittings ensure reliable and comfortable operation

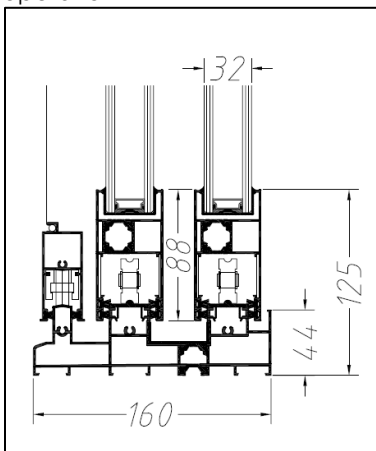

Design Features

- Thermal break and non-thermal break fully interchangeable Sliding System.
- Two Track thermal Break Sliding sashes plus one track for fly screen.
- Up to 4 panels sliding configurations.
- Integrated Fly screen sash.
- System can add fixed panels with integrated profiles.
- Thermally enhanced extrusions incorporating glass fiber reinforced polyamide strips
- Good Acoustic performance.
- Robust and durable design allowing up to 150 kg panel weight.

Options and Configurations

Options

- Accepts up to 32 glass pane width.- 6/20/6
- Sliding Doors multi lock fittings.
- Three track system : Two leaves tracks and Fly screen track
- Available in single or dual color, polyester powder coating and anodized finishes

Configurations

- (A) One Panel Sliding
- (B) Two Panel Sliding
- (C) Three Panel Sliding
- (D) Four Panel Sliding
- Fixed panels combined with sliding panels.
- Single, Double Tracks and Fly screen track





Hinged Windows

Optimus H.T.B.70.

The H.T.B. 70 Thermal Break casement frame window system provides an ideal heavy duty thermal insulated window for different types of designs and functions.

The system is available in a range of styles and can be top, bottom or side hung to meet the needs of your project. Another function of Tilt and Turn application can be provided easily by adding a special fitting for the same window.

The H.T.B. 70 range has been developed to retro fit special use for Hospitals, Schools, Commercial and high level application. The range is available in a wide variety of standard colors as well as any RAL color and includes the proper hardware.

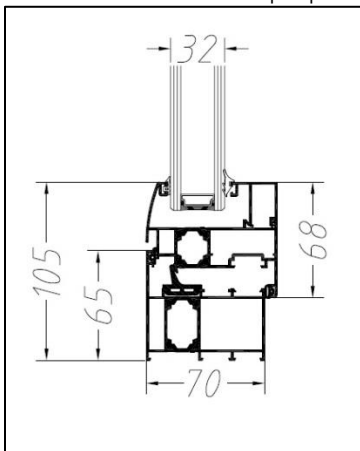

Design Features

- Slim sightlines with eye catching nice profile design.
- Heavy duty sections.
- Unique polyamide thermal break design to improve performance
- Good acoustic performance.
- Accommodates standard hardware.
- Variety designs as per application.

Options and Configurations

Options

- Accommodates up to 42 mm glazing units to achieve required thermal and acoustic performance.
- Casement clips available for easy fit and removal of dummy vents.
- Dedicated fixing straps for ease of installation
- Available in single or dual color option, polyester powder coating and anodized finishes
- Internally beaded option for ease of site glazing on high-rise applications
- Integrated deep head profiles for ease of trickle ventilation

Configurations

- Top, Bottom, Side Hung and Inward Opening
- Different types of single and dual opening actions, Tilt, Tilt & Turn, and Hinged.
- High level fittings and accessories.





Design Features

- Internally beaded with a soft line or square detail to all external doors and panels
- Heavy Duty wheels per carriage ensures smooth and consistent operation
- Unique, flush T-handle that allows maximum door opening and squared stacking panels
- Glazing sizing range up to 28mm : 6/16/6

Options and Configurations

Options

- Doors and panels can be used in a variety of configurations, style and design
- All configurations are available in both open-in and open-out options
- Polyester powder coating and anodized finishes
- Chamfered and square bead options
- Low threshold option which can be configured to achieve complete insulation between inside and outside.

Configurations

- The folding sliding door system is available in a wide range of configurations
- 2- 12 panels are available per door.
- Panels can be stacked inside or outside, to the left or right, or split stacked on both sides.
- Corner free Tube option is available ; to ensure better opening without any columns at corner with high insulation.

FOLDING DOOR SYSTEM

Optimus F.D. 60

Versatile and flexible, the market leading F.D. 60 aluminum folding sliding door system is available in a wide range of configurations to create the look you desire.

Multiple panel doors can be combined with open-in or open-out options, in a variety of styles to create a wide expanse of open area.

The narrow profile ensures that maximum glazing is achieved, flooding rooms with light even when closed.

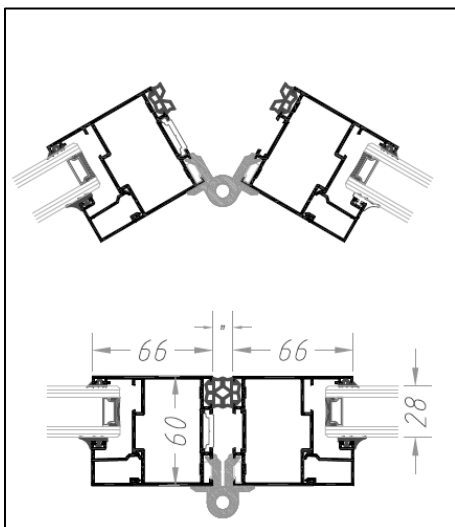



Aluminum + Wood Hinged Windows Optimus H.W.T.B.70.

The H.W.T.B. 70 is a combined Thermal Break casement frame covered by Wood frame window system provides an ideal heavy duty thermal insulated window with Elegant view from Inside.

The system is available in a range of styles and can be top, bottom or side hung to meet the needs of your project. Another function of Tilt and Turn application can be provided easily by adding a special fitting for the same window.

The H.W.T.B. 70 range has been developed to suite elegant residence, Hotels, Castle and people who search for High quality and wood look from inside.

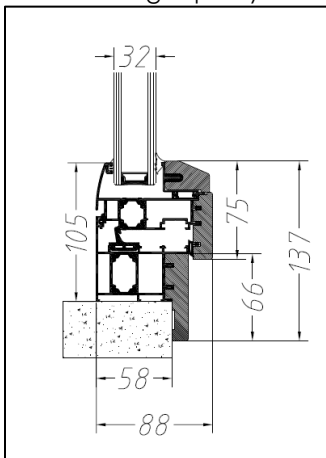

Design Features

- Solid wood frame from inside part.
- Wood Architrave can be applied around the window.
- Heavy duty sections.
- Unique polyamide thermal break design to improve performance
- Good acoustic performance.
- Accommodates standard hardware.
- Variety designs as per application.
- Variety of Wood options can be provided.

Options and Configurations

Options

- Accommodates up to 32 mm glazing units to achieve required thermal and acoustic performance.
- Casement clips available for easy fit and removal of dummy vents.
- Dedicated fixing straps for ease of installation
- Variety of Wood and Aluminum Color.
- Internally beaded option for ease of site glazing on high-rise applications
- Integrated deep head profiles for ease of trickle ventilation

Configurations

- Top, Bottom, Side Hung and Inward Opening
- Different types of single and dual opening actions, Tilt, Tilt & Turn, and Hinged.
- High level fittings and accessories.



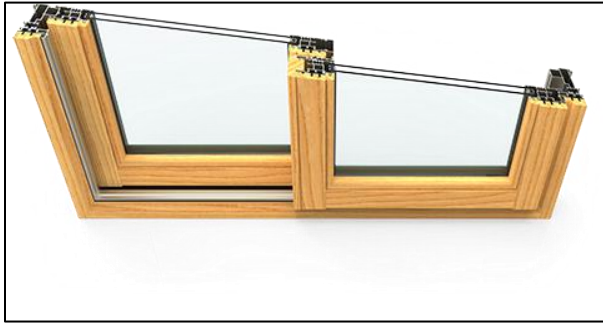

Sliding and Wood Sliding Optimus S.W.T.B. 160.

The S.W.T.B.160 aluminum sliding door with Wood frame is a multi-configuration in-line sliding system that allows you to specify and design the most suitable solution for your project.

The system is designed to cover the needs of Heavy duty Sliding Windows and Doors with Wood frames, which is suitable and needed for elegant residences, villas, Hotels, and castle.

Thermally broken system profiles with integrated fly screen track and sash is designed to cover market needs.

The system is available with fixed and sliding panels, as well as single and double track options. Outstanding thermal performance and the highest quality fittings ensure reliable and comfortable operation

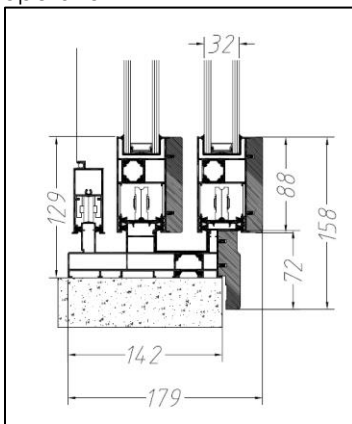

Design Features

- Thermal break system.
- Wood frame for the inner side of window.
- Wood Architrave can be added to wood frame around the window.
- Two Track thermal Break Sliding sashes plus one track for fly screen.
- Up to 4 panels sliding configurations.
- Integrated Fly screen sash.
- System can add fixed panels with integrated profiles.
- Thermally enhanced extrusions incorporating glass fiber reinforced polyamide strips
- Good Acoustic performance.
- Robust and durable design allowing up to 150 kg panel weight.

Options and Configurations

Options

- Accepts up to 32 glass pane width.- 6/20/6
- Sliding Doors multi lock fittings.
- Three track system : Two leafs tracks and Fly screen track
- Available in single or dual color, polyester powder coating and anodized finishes

Configurations

- (A) One Panel Sliding
- (B) Two Panel Sliding
- (C) Three Panel Sliding
- (D) Four Panel Sliding
- Fixed panels combined with sliding panels.
- Single, Double Tracks and Fly screen track





Sliding Windows

Optimus SL105

Design Feature

- Aluminum Non thermal profiles
- Two Glass sash, horizontal sliding.
- Separate fly screen sash optional , external
- Double glazing sash , up to 24mm
- 10.7 cm window width
- EPDM glazing gasket
- Special brushes to prevent air leakage.
- 69mm lower sash profile
- 59 x 36.5 mm interlock profile

SL105 Options

Options

- Single and double glazing system.
- Double moving sash.
- One moving sash and fix sash.
- Manual lock for sliding door option.
- Three sashes on two rail frame.
- Fiber mesh fly screen.

